



www.kings-group.net

25 Silver Street
Enfield Town EN1 3EF
Tel: 0208 364 4118

Beresford Gardens, Enfield, EN1 1NP
Offers In The Region Of £270,000

**** New lease on completion**** We are pleased to present this well-proportioned ground floor flat, ideally located in the highly sought-after area of Enfield, just a stone's throw from Enfield Town. This property offers a fantastic opportunity for buy-to-let investors or first time buyers alike.

The flat benefits from spacious, light-filled bedrooms, a fitted kitchen, and a comfortable lounge area, all arranged to maximise living space and functionality and the three piece bathroom is well-appointed. Outside, residents enjoy access to well-maintained communal grounds and gardens, providing a peaceful and green setting. The property is also just moments from a wide range of local shops, supermarkets, and amenities, as well as Enfield Town Shopping Centre.

Transport links are excellent, with Enfield Town Station within walking distance, offering a direct service into London Liverpool Street Station. Road access is equally convenient with the A10 and M25 nearby, making commuting or travel further afield hassle-free.

To arrange a viewing or find out more, please get in touch today.

Energy Efficiency Rating		
	Current	Potential
Very energy efficient - lower running costs		
(92 plus) A		
(81-91) B		
(69-80) C		
(55-68) D		
(39-54) E		
(21-38) F		
(1-20) G		
Not energy efficient - higher running costs		
England & Wales	EU Directive 2002/91/EC	

Environmental Impact (CO ₂) Rating		
	Current	Potential
Very environmentally friendly - lower CO ₂ emissions		
(92 plus) A		
(81-91) B		
(69-80) C		
(55-68) D		
(39-54) E		
(21-38) F		
(1-20) G		
Not environmentally friendly - higher CO ₂ emissions		
England & Wales	EU Directive 2002/91/EC	

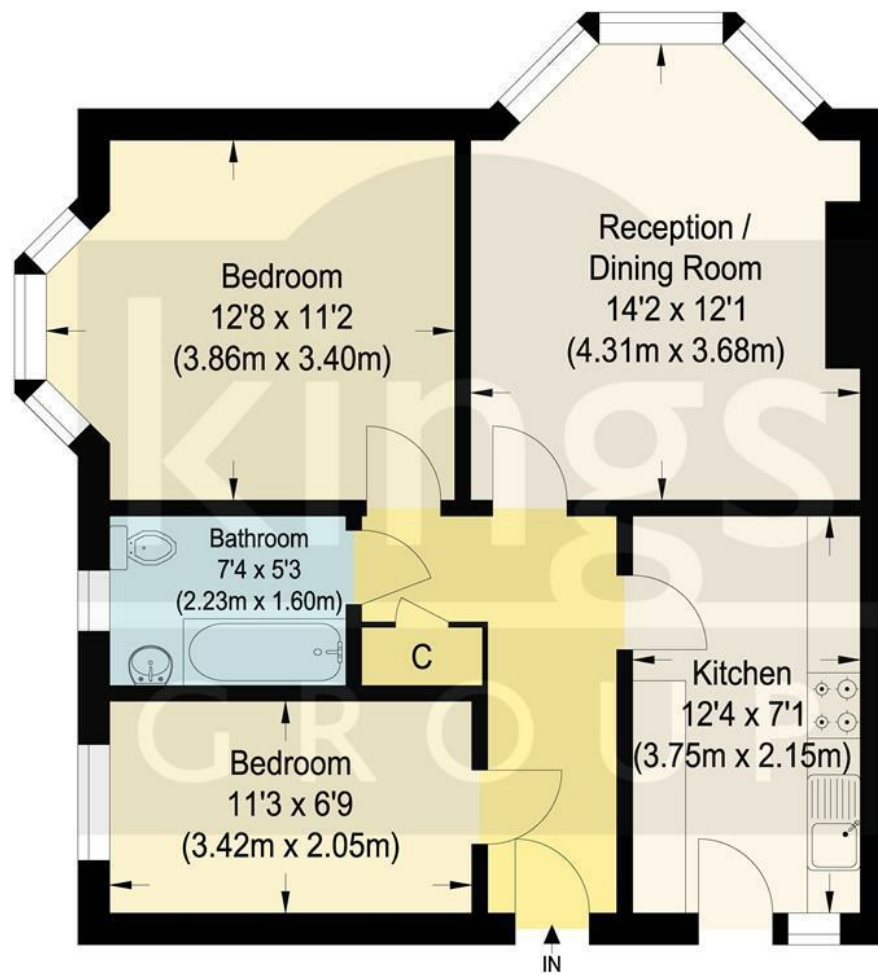

Ground Floor



Beresford Gardens

Approximate Gross Internal Floor Area : 54.60 sq m / 587.70 sq ft
 Illustration for identification purposes only, measurements are approximate, not to scale.



Associated Offices in London, Essex and Hertfordshire
 Kings Head Office Tudor Lodge, Burton Lane, Goffs Oak, Hertfordshire EN7 6SY Tel: 01707-872000



